

## ZXB QUICK START GUIDE

If fitting to the deck, install the jammers forward of the winch, close enough for easy operation of the toggle and latch, ensuring enough space is left behind the jammer for removal of the jaw assembly for maintenance. The ZXB Jammer is supplied with M10 Socket Countersunk fasteners (A4-70 stainless steel) which require a 6mm Allen key and 17mm spanner.

**Side Mounting:** This will require a custom mounting plate, please contact Spinlock for more details

**Mast Mounting:** Mount as standard – the externally located fasteners allow direct mounting to blind holes



**THE JAMMERS ARE NOT DESIGNED TO WITHSTAND HIGH SIDE LOADS. IF THE LEAD ANGLE TO THE WINCH IS GREATER THAN 10°, FIT LEAD BLOCKS OR ORGANISERS AFT OF THE JAMMERS. FOR DETAILS OF OUR TSR HIGH LOAD AFT ORGANISER RANGE SEE SPINLOCK.CO.UK/TSR**

### How to Use

ZXB Jammers are relatively simple to operate, but because of the high loads it is important to fully understand their function before use.

1. To open: Pull toggle out until latch button clicks up. The latch must be fully engaged to hold the jaws open. The rope can now be inserted and run freely in either direction.
2. To lock line: Hoist sail and tension with winch. Before easing load from the winch, press the Latch Button to allow the jaws to engage onto the rope. Once the jaws are fully engaged onto the rope, ease the load from the winch. The jaws will slide with the loaded rope to secure the load.
3. To Re-Open: The full load on the rope must be returned to the winch before the jammer can be opened. Never attempt to the open jammer without transferring the load onto the winch. Only when the load is secured on the winch is it safe to pull the Toggle and jaws back until the latch button is engaged. The jaws are now fully locked open and the rope can be controlled from the winch to run freely through the jammer.

### SAFETY FEATURE

**ZXB JAMMERS CAN ONLY BE RELEASED AFTER THE ROPE LOAD HAS BEEN TRANSFERRED TO THE WINCH**

### Maintenance

Spinlock ZXB Jammers are made from the highest quality materials for durability and low maintenance in a harsh marine environment. ZXB is carefully designed for easy and regular servicing at sea. The life and performance will be improved if regularly flushed with fresh water. The jaws can be easily removed for inspection and replacement

- Check for excessive wear on the grip surface. Replace if necessary.
- Check the white bearing surfaces are clean and smooth. Replace if necessary.
- Ensure all internal faces are clean and smooth.
- The white jaw bearings do not require lubrication. Keep free of dirt and debris with fresh water.

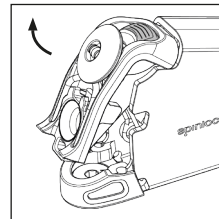
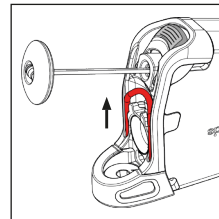
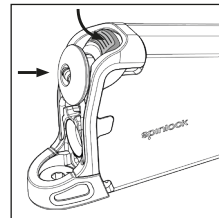
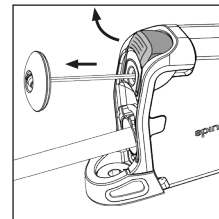

For further information and instructions on maintenance of ZXB Jammers, please refer to the Spinlock website, YouTube Channel or contact [prosupport@spinlock.co.uk](mailto:prosupport@spinlock.co.uk)

## Remote Operation Set Up and Use

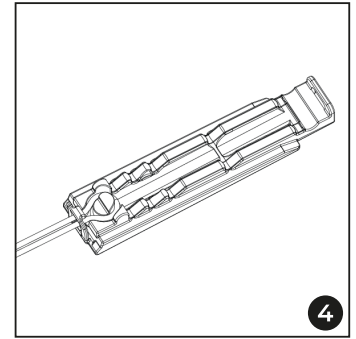
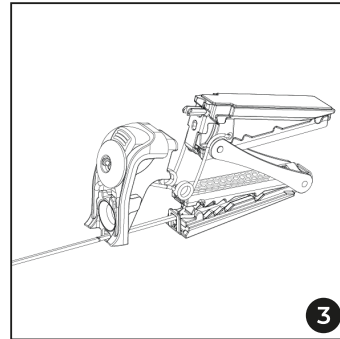
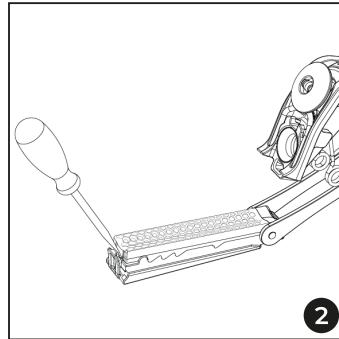
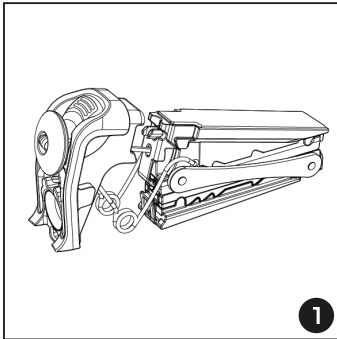

1. Remove jaw set (see jaw removal guide).
2. Using a screwdriver, carefully prise the rear clip of the lower jaw to lift the jaw grip.
3. For the remote line, create a 50mm loop in 2mm cord. Pass the loop through the square hole at the bottom of the rear cover, then through the clip on the lower jaw.
4. Hook the loop over the round peg in the lower jaw.
5. Snap shut the jaw grip onto the lower jaw. If the lower jaw has come away from the jaw assembly, hook the front of the jaw grip into the corresponding slot in the front of the lower jaw. Ensure correct alignment and positioning as shown. Replace the jaw set into the body, making sure to push the staple into place. Finally press the latch button to allow operation of the latch mechanism.

